

\$.99 per square foot *

230 JOHN HANCOCK ROAD TAUNTON, MASSACHUSETTS

Boston Commercial Properties is pleased to present 230 John Hancock Road in Taunton, MA. This is a first-class distribution facility that is strategically located in the Myles Standish Industrial Park off Route 495 and between Routes 24 and 95. Corporate neighbors include Graybar Electric, General Dynamics, Pepsi Cola and Chadwick's of Boston. Amenities include a hotel and conference center, public transportation, FedEx, banking, and city employer assistance and training programs.

* The First Year of a Five (5) Year term

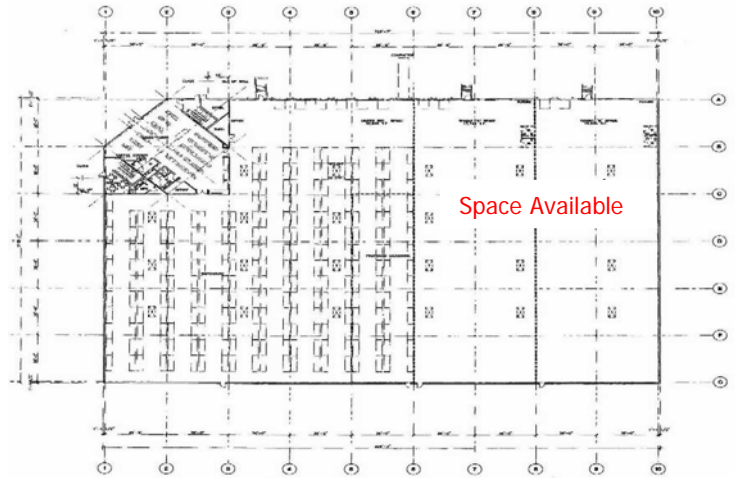

SPECIFICATIONS:

<u>Space Available:</u>	31,779 sf
<u>Building Size:</u>	70,745 sf
<u>Construction:</u>	Tilt-up slab concrete
<u>Availability:</u>	Immediate
<u>Office space:</u>	1,232 sf
<u>Lease Rate:</u>	\$4.90 NNN per sf
<u>Ceiling Height:</u>	30 ft. clear
<u>Fire Protection:</u>	ESFR sprinkler system
<u>Bay Spacing:</u>	36 ft. x 36 ft.
<u>Loading:</u>	4-6 tailboard loading docks

For further information or to schedule a tour, please contact:

Warren Brown
Boston Commercial Properties, Inc.
275 Grove St., Suite 2-400, Newton, MA 02466
Phone 781-239-8233 Fax 781-239-8133
Email: warren@bostoncommercialproperties.com
www.bostoncommercialproperties.com