

10 DAN ROAD CANTON, MASSACHUSETTS

Boston Commercial Properties is pleased to present 10 Dan Road in Canton. This is a first-class 110,000 square foot flex/warehouse facility consisting of 50,000 sf of warehouse space and 60,000 of flex, lab, and air-conditioned R&D space. The property is well located in the Canton Commerce Center on Route 138 and in close proximity to Route 128.

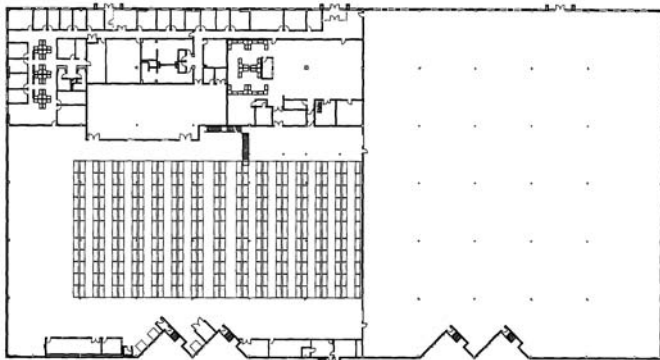
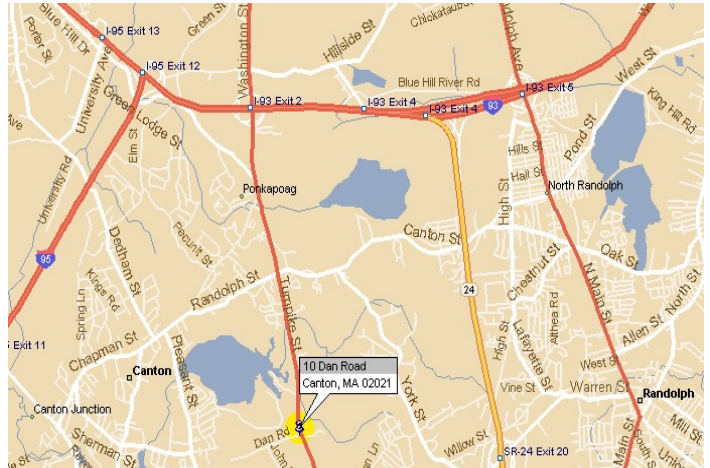

Total Building Size:	110,000 sf
Space Available:	110,000 sf (will divide)
Real Estate Taxes:	Approximately \$1.83 per sf
Term:	Flexible
Parking:	350 spaces
Ceiling Height:	22 foot clear
Loading:	Eight tailboard loading docks
Bay Spacing:	40 ft. x 40 ft.
Construction:	2001; Architectural block
Fire Protection:	Full wet sprinkler system
Heat:	Gas-fired suspended heaters

For further information or to schedule a tour, please contact:

Warren Brown
Boston Commercial Properties, Inc.
275 Grove St., Suite 2-400, Newton, MA 02466
Phone 781-239-8233 Fax 781-239-8133
Email: warren@bostoncommercialproperties.com